

# R 101 DN 25

**Pe = Pu max.** 8 bar  
**Pa = Pd** 22-1.200mbar  
**Q max.** 200 Nm<sup>3</sup>/h  
 (300) Nm<sup>3</sup>/h\*

## KG-Werte

**V 17,5** 186 Nm<sup>3</sup>/h  
**V 27,5** 459 Nm<sup>3</sup>/h

## Gas Spezifikation

Geeignet für Gase der Gasfamilien 1, 2, 3 (DVGW-G260) und nicht aggressive Gase.

**Umgebungs-/ Betriebstemp.** -20...+60°C

**Einbaulage** beliebig

**Strömungsgeschwindigkeit** max. 30m/s  
 (Grenzwert 60m/s)\*

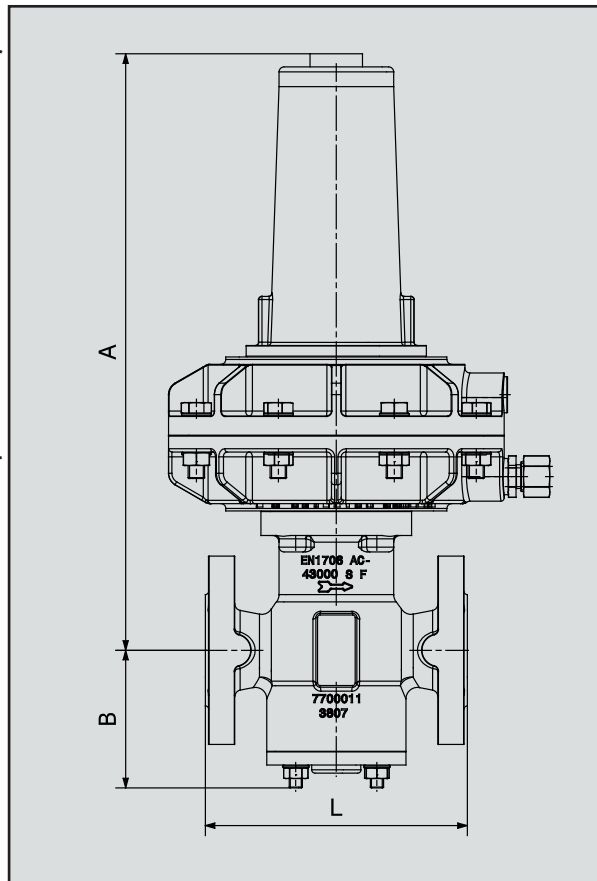

## Sonderausführungen:

HD-Spindel

\* Rücksprache MEDENUS

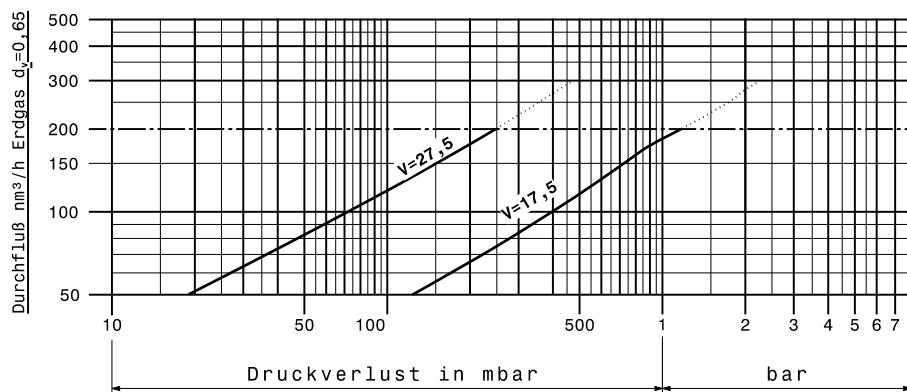

**Pd < 200 mbar**  
**200 - 800 mbar\*\***  
 10,5kg  
 PN16  
 A=346mm  
 B= 84mm  
 L=160mm

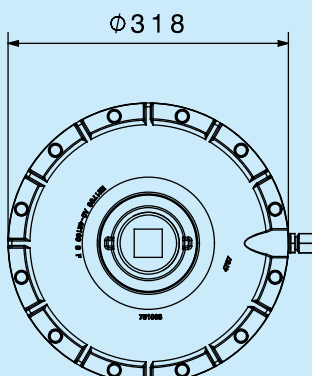

**Pd < 750 mbar**  
**750 - 1.200 mbar\*\***  
 8kg  
 PN16  
 A=364mm  
 B= 84mm  
 L=160mm

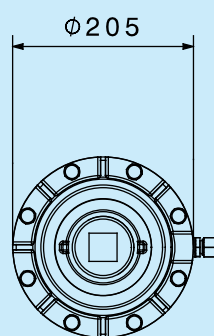

\*\* HD-Spindel

**Pd < 1.200 mbar**  
 6,5kg  
 PN16  
 A=356mm  
 B= 84mm  
 L=160mm

